

EFC929SA

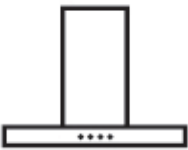

EN    Cooker hood

ภาษาไทย    เครื่องดูดควัน

Cooker Hood (Tudung Hisap)

User manual

คู่มือการใช้งาน

Panduan pengguna



**Electrolux**



## Electrolux Thinking of You

Electrolux is the global leader in home appliances, and founded in 1919 in Sweden, it has nearly a hundred years of experiences in the professional R&D and manufacturing of household appliances. It is Electrolux's mission to make consumers get happiness during the use of home appliances.

More than 40 million families in more than 150 countries and regions are using Electrolux every year, and more than 50% of the world's five-star hotels are using professional kitchen equipment provided by Electrolux. With the consumer experience oriented leading design, Electrolux has now become the "noble" in the global home appliance brands.

Electrolux products cover various large and small household appliances and commercial appliances such as the refrigerator, washing machines, air conditioners, hoods, Gas Hob, disinfectors, electric water heaters, and vacuum cleaners.

Electrolux focuses on the technological innovation, it has set up global R&D centers respectively in 6 countries to perform the product development from the appearance design to the function improvement, and to elaborately work out the products truly meeting customer and professional application needs through the extensive understanding of consumers.

# CONTENTS

1. PRODUCT DESCRIPTION .....	3
2. PRECAUTIONS .....	3
3. PACKING LIST .....	3
4. TECHNICAL DATA .....	4
5. CIRCUIT DIAGRAM .....	4
6. INSTALLATION .....	5
7. USE .....	6
8. MAINTENANCE .....	7
9. TROUBLESHOOTING .....	8
10. PARTS INSTRUCTIONS .....	9
11. CONSUMER CARE CENTER .....	10

## 1. PRODUCT DESCRIPTION

The romantic European style range hood has the following five advantages:

1. Avant-garde modeling, with sufficient fashion  
The streamlined design, elegant and fashionable appearance, and touch control fully show the blues cooking style.
2. With strong suction, fumes can be cleared thoroughly  
The integral stretching hood is more suitable for the smoke area of the Asian kitchens, and the fan with the large exhaust capacity is used to exhaust the smoke more thoroughly.
3. Low noise  
The well-designed fan system based on the principle of aerodynamics ensures a smooth and quiet operation.
4. Easy to clean  
The tapered oil strainers with large air intake from four sides ensure a full absorption of fumes and avoid the oil spillage, and make the oil collected into the oil cup, thus avoiding the incomplete cleaning of the traditional European style hood.  
Also, Thanks for Nano Coating on the surface of filter that can to help for significantly reduce accumulation of grease.
5. Oil channel characteristics  
Unique multiple oil channels design ensures no oil accumulation, oil drip, and oil spillage.

## 2. SAFETY PRECAUTIONS

1. The power supply shall be matchable with this device, and the three-conductor power outlet must be reliably grounded.
2. The hood shall be used when the cooker is consuming the gas or other fuels, and it shall be installed in the well ventilated room (but not installed in the places with strong air convection to avoid weakening the exhaust effect).
3. The hood is prohibited to be directly baked by the fire.
4. No water is allowed to enter the electrical components such as motor and switch.
5. Please do not change the specifications of the electrical parts, and do not change the internal lines or graft other lines.
6. For any trouble in use, please refer to the TROUBLESHOOTING before contacting the customer service center, if such trouble still cannot be eliminated, please pull out the power plug of the hood and contact our customer service center.
7. If the light is damaged, please replace with the same type of light.
8. This machine is a household appliance, and shall not be used in special environment.
9. The oil in the cup, once reaching two-thirds of oil storage, shall be promptly cleaned to prevent overflow.
10. Please clean the oil strainer under the panel lock status, and after the oil strainer installed in place, unlock the panel to enable the operation keys. It shall be avoided that the malfunction of the sliding panel results in the damage of the hood or oil strainer.
11. Disassembly only by professionals to avoid serious consequences.
12. If the hood is not cleaned as described by the user manual, the hood will be at a risk of fire.
13. The wall for mounting the hood shall have a certain support strength to withstand the weight of the hood, and the wall must be incombustible.
14. Unless supervised or guided, persons with disabilities or persons without knowledge and experience cannot use the hood.
15. The supervised children cannot play the hood.
16. The gas exhausted from the hood cannot be discharged into the exhaust pipe of the combustible gas or other fuels.

## 3. PACKING LIST

Please check against the packing list, for any missing or loss:

1. Which is under the responsibility of the company or the seller, please ask the seller to handle;
2. Which is under the responsibility of the customer itself, please contact the seller or the company;
3. Please refer to page 9 for details of accessories.

Model	Name	Qty.
1	Hood	1 set
2-3	User manual	1 pc
4	Duct Φ 195X2000	1 pc
5	Duct adapter Φ 195 to 150/160/170	1 pc
6	Oil cup	1 pc

Model	Name	Qty.
7	Hood hanging plate	1 pc
8	Trim cover hanging plate	2 pcs
9	Expansion tube, wood screws	6 sets
10	St2. 9X10 Tapping screws	2 pcs
11	Screws for trim cover	4 pcs
12	Safety stop, ST5X19 screws, expansion tube	1 set

#### 4. TECHNICAL DATA

Model	EFC929SA
Dimensions (mm)	W900xD505xH705-980mm
Net weight	33kg
Power supply	220-240V~50Hz
Total rated input power	223 W
Motor input power	220 W
Lighting power	≤ 1.5 Wx2
Air pressure	350
Noise	69 dB
Max. static pressure	390
Stir-fry air pressure	400
Normal odor reduction	≥ 98%
Instant odor reduction	≥ 70%
Grease separation	≥ 90%
Full pressure efficiency	≥ 25%

#### 5. CIRCUIT DIAGRAM

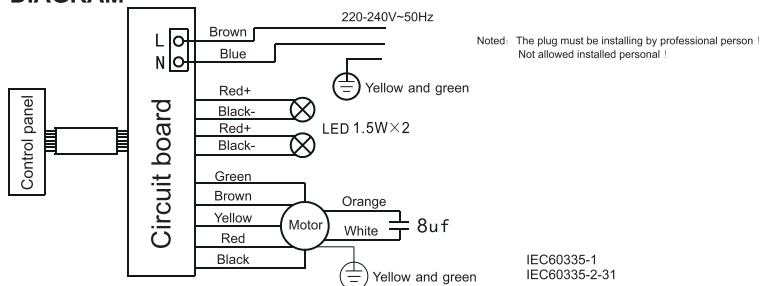

## 6. INSTALLATION

### (I) Installation requirements

1. The wall for mounting the hood shall have a certain support strength to bear the weight of the hood.
2. The hood shall not be in contact with the electric lines inside and outside of the wall to avoid electric shocks.
3. The hood shall not be installed in the environment with strong air convection to avoid weakening the exhaust effect.
4. The distance from the air outlet to the upper vent hole shall be  $\leq 1.5$  m, so as to avoid that the exhaust effect is weakened by the outlet with excessive length or too many bends (usually one).
5. The mounting size for the outlet laid through the cabinet or the ceiling is shown in Figure 1.

### (II) Installation method

1. The distance between the bottom of the hood and the pot support surface of the stove is 650 mm;
2. As shown in the installation diagram, drill two holes in the wall with a plastic expansion of  $\Phi 8$  mm and the hole spacing of 180 mm, embed two plastic expansion tubes, and fasten the hood hanging plate (accessories) to the wall with 2 wooden screws.

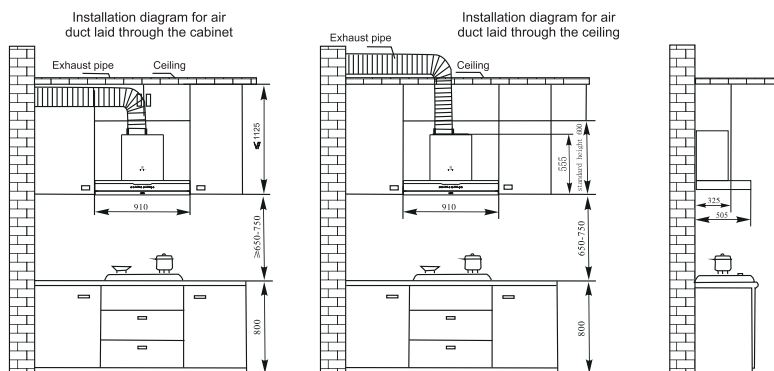
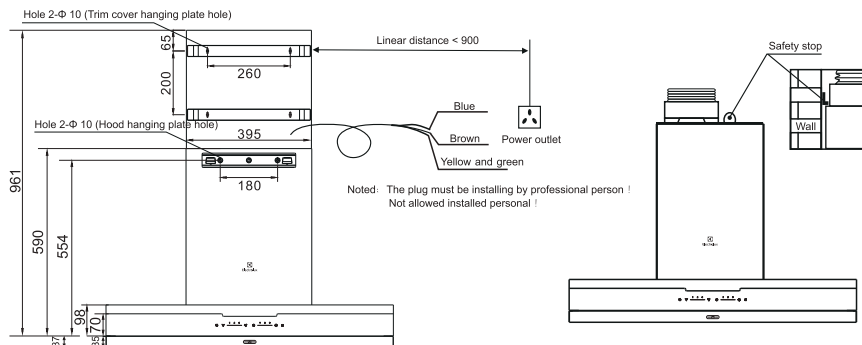

Figure 1

3. If you need to install the inner trim cover, please drill four  $\Phi 8$  mm holes in the appropriate position over the hood hanging plate, insert 4 plastic expansion tubes respectively, and fix the trim cover hanging plate to the wall with 4 wooden screws.
4. Fix the air outlet seat to the upper part of the hood, insert the air duct into the bottom of the ring groove (note the direction) of the air outlet seat, and use two ST2. 9X10 tapping screws to fix the air duct to the air outlet seat.
5. Hang the hood to the hanging plate and confirm that the hood is firm and kept horizontal without any skewness.
6. After the hood is installed in place, determine the impact drill hole position, firmly bury the expansion tube, and fix the safety stop as shown in the installation diagram. Insert and tighten ST5X19 screws (to prevent the accidental decoupling of the hood body under the external force).
7. Lead the other end of the air duct to the outside, and check that the duct has no aerated and deflated wall, the duct is flexible with tight interface, and the check valve blade is opened and closed smoothly.
8. Pull out the inner trim cover and fasten it to the hanging plate with 4 special screws (accessories).
9. Insert the oil cup evenly into the hitching leg at the bottom of the mesh cover, and push it in place horizontally.
10. Insert the power plug of the appliance into a reliably grounded outlet, test the appliance to check whether the functions of the appliance are normal.

**Note:** The diameter of the exhaust wall hole shall be close to the diameter of the air duct and shall not be too small. Otherwise it will cause poor exhaust, noise rising and air capacity decrease.



### (III) Installation check

The user shall first confirm that the hood is correctly installed in place.

### (IV) Power

Range hood of the power supply cord connected to the fixed wiring circuit, power supply cord to the power grid is needed between containing a > 3 mm from the disconnect switch.

Upon the confirmation of the installation, insert the power plug of the appliance into a reliably grounded outlet, and the applicable power supply is 220-240V~50Hz power.

## 7. USE



### Standby mode:

When the hood is energized for the first time or re-energized after power interruption, the hood will make a sound for confirmation, and the keys on the control panel will flash from left to right. And then the hood is in standby mode.

### Fan control:

Low, medium, and high air speeds: in standby mode, touch "Fan" to open the fan. When the hood is energized for the first time or re-energized after power interruption, the range hood is at medium speed by default. Then touch "Fan" to open the air speed used last time. You can also directly touch the speed key on the right of "Fan" to select the desired speed.

Stir-fry instant suction speed: in the working mode of the fan, touch "Stir-fry instant suction" key to enable the stir-fry instant suction speed. At this time, the "Stir-fry instant suction" key starts flashing. The stir-fry instant suction speed, after working for 1 minute, will automatically shift down to the high speed.

### Delayed shutdown:

During the operation of the fan, touch "Delayed shutdown" to enable the delay shutdown function. At this time, the "Delayed shutdown" key starts flashing, and the hood will automatically shut down after working for 5 minutes. If you want to cancel the delayed shutdown function, you can touch the "Delayed shutdown" key again, then the "Delayed shutdown" stops flashing, and the delayed shutdown will be disabled.

The delayed shutdown function only works for the fan but does not work for the light. That is, if the delayed shutdown function is activated when the fan function and lighting functions are both enabled, after working for 5 minutes, the hood will only automatically turn off the fan, while the lights continue to work.

### Fan shutdown:

In the working mode, touch "Fan" to turn off the fan. In the case of activating the delayed shutdown function, you can also touch the "Fan" to directly turn off the fan.

The delayed shutdown function and the stir-fry instant suction can be activated only when the fan is turned on, and the control panel will not display the corresponding “☺” and “☹” icons when the fan is off.

#### Light control:

In the standby mode, touch “☼” to turn on the light, when the hood is energized for the first time or re-energized after power interruption, the range hood is in at medium brightness by default. Then touch “☼” to open the brightness used last time. You can also directly touch the brightness key on the right of “☼” to select the desired brightness.

After the cumulative working hours of the hood are up to 50 hours, when the hood is in working condition, the cleaning prompt “⦿” on the control panel will light up to remind that the greasy dirt of the oil strainer and oil cup are too much and need to be cleaned. Please clean the oil cup and oil strainer according to the method in (how to clean the oil cup and oil strainer). After cleaning, please touch “⦿”, then the “⦿” goes off and the recounting starts.

#### Key lock:

In the standby mode, touch the key lock “🔒” for 3 seconds, then the “🔒” key lights up to activate the key lock function; in the working mode, touch the key lock “🔒” for 3 seconds, the light remains the previous state, if the fan is in working condition, the fan will stop working, while the “🔒” key will light up to activate the key lock function. At this time, touch the keys other than the key lock “🔒”, the hood will make a sound, meanwhile the key lock “🔒” will flash to prompt that the hood cannot be operated until the key lock is disabled.

To disable the key lock function, you can touch “🔒” for 3 seconds, and the “🔒” key will light off, then you can normally operate the hood.

#### Test mode:

Within 1 minute after the powerup, touch “☹” for 3 seconds, and all keys on the control panel will flash for 10 seconds. When the key is flashing, touch “☹” for 3 seconds again, and the hood enters the test mode. In the test mode, the cleaning prompt “⦿” key will keep flashing, the fan will be running at the stir-fry instant suction speed, and the range hood can be subject to air capacity, noise and other performance tests at such speed.

In the test mode, if you open the stir-fry instant suction speed, the hood will continue to work rather than just working for a minute.

If you want to exit the test mode, you can touch “☹” for 3 seconds, within 10 seconds of the key flashing, again touch “☹” for 3 seconds again, then the range hood will exit the test mode. You can also pull out the power plug, after the range hood completely powers off, insert the plug, and the hood will also exit the test mode.

The test mode is used for laboratory testing only, please do not enter the test mode in daily use, so as to avoid the damage to the range hood.

## 8. MAINTENANCE

### 1. Light disassembly

If need to replace lamp, please contact our service team. You shouldn't take off it by yourselves.

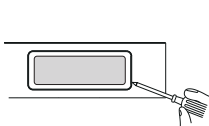

- ① Insert a slotted screwdriver or relatively small things into the gap between the light shade and the hood.

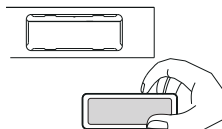

- ② Apply the force outward, remove the light, pull out the connector, and replace the light.

### 2. Switch disassembly

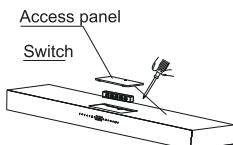

In the upper part of the hood (as shown in the figure), first use a screwdriver to loosen the screw of the access panel, remove the access panel, and then loosen the screw of the switch with a screwdriver to remove the switch.



## 9. TROUBLESHOOTING

- Be sure to pull out the power plug before handling the fault

Indication	Signification	Elimination
Both the light and the motor are not working	The power plug is not well inserted	Insert the power plug well
	No power output	Please ask electrician for site repair
The motor is working properly, but the light is not on	Light failure	Replace the light (please contact our customer service center for site replacement)
	Control panel failure	Replace the control panel (please contact our customer service center for site replacement)
The light is working properly, but the motor dose not work	The capacitor is poorly contacted or damaged	Please contact our customer service center for site replacement
	The motor is damaged or the power panel is damaged	Please contact our customer service center for site replacement
The fan wheel has an abnormal sound	The fan wheel is loose, and the wheel cap is not tightened	Tighten the fan wheel cap
Speed 1 cannot work, but other speeds can work	The control switch is damaged	Replace the switch (please contact our customer service center for site replacement)
The exhaust effect is poor	The hood is mounted at an excessively high position	Decrease installation height
	Two windshields are not fully opened	Check the windshield and ensure it can act flexibly
	The air convection is too strong around the hood	Properly close doors and windows
	Excessive greasy dirt	Clear greasy dirt
	Not at the max speed	Adjusted to the max speed

### WARNINGS:

1. Pull out the power plug when connecting the plug-in unit or making replacement;
2. If the power cord of the hood is damaged, it must be replaced by the professionals from the manufacturer, the maintenance department or the similar departments.
3. It is prohibited to inhale the flame into the hood body to prevent against accidents.

## 10. PARTS INSTRUCTIONS

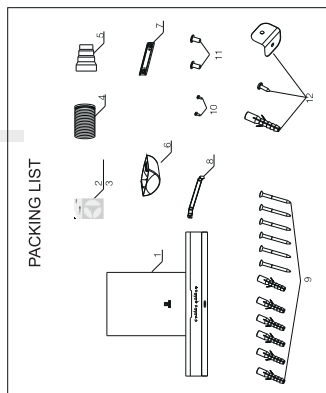
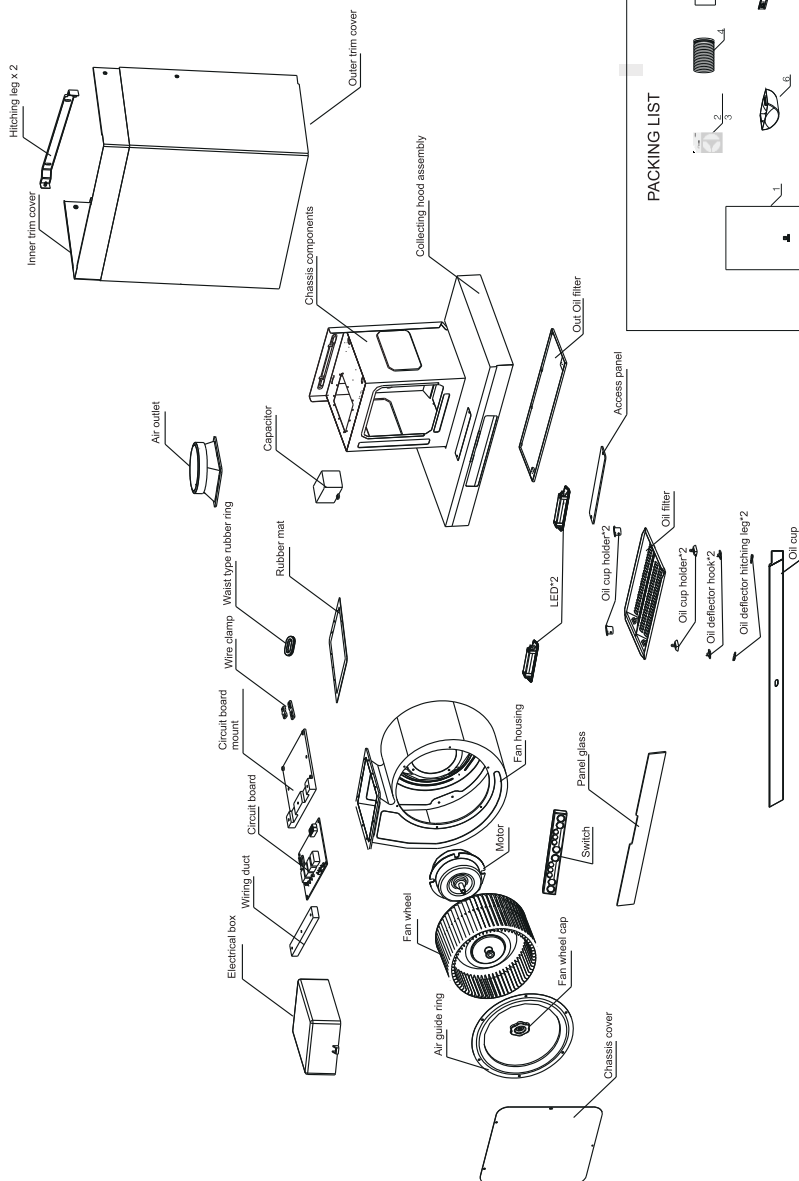

## 11. CONSUMER CARE CENTER

### Indonesia

Consumer Care Center Tel: (+62 21) 522 7180  
PT. Electrolux Indonesia  
Gedung Plaza Kuningan  
Menara Utara 2nd Floor,  
Suite 201, Jl. HR Rasuna Said  
kav C 11-14, Karet Setiabudi  
Jakarta Selatan 12940  
Office Tel: (+62 21) 522 7099  
Office Fax: (+62 21) 522 7097  
Hotline service: 08041119999  
Email: [customercare@electrolux.co.id](mailto:customercare@electrolux.co.id)

### Malaysia

Consumer Care Center Tel: 1300-88-11-22  
Electrolux Home Appliances Sdn. Bhd.  
Corporate Office Address: Unit T2-7, 7th Floor, Tower 2,  
Jaya33 Hyperoffice, No. 3, Jalan Semangat, Seksyen 13,  
46100 Petaling Jaya, Selangor  
Office Tel: (+60 3) 7843 5999  
Office Fax: (+60 3) 7955 5511  
Consumer Care Center Address: Lot C6, No. 28,  
Jalan 15/22, Taman Perindustrian Tiong Nam,  
40200 Shah Alam, Selangor  
Consumer Care Center Fax: (+60 3) 5524 2521  
Email: [malaysia.customercare@electrolux.com](mailto:malaysia.customercare@electrolux.com)

### Philippines

Consumer Care Center Toll Free: 1-800-10-845-CARE 2273  
Consumer Care Hotline: (+63 2) 845 CARE 2273  
Electrolux Philippines, Inc.  
10th Floor, W5th Avenue Building  
5th Avenue Corner 32nd Street  
Bonifacio Global City,  
Taguig Philippines 1634  
Trunkline: +63 2 737- 4756  
Website: [www.electrolux.com.ph](http://www.electrolux.com.ph)  
Email: [wecare@electrolux.com](mailto:wecare@electrolux.com)

### Singapore

Consumer Care Center Tel: (+65) 6727 3699  
Electrolux S.E.A. Pte Ltd.  
1 Fusionopolis Place,  
#07-10 Galaxis, West Lobby  
Singapore 138522.  
Office Fax: (+65) 6727 3611  
Email: [customer-care.sin@electrolux.com](mailto:customer-care.sin@electrolux.com)

### Thailand

Consumer Care Tel: (+66 2) 725 9000  
Electrolux Thailand Co., Ltd.  
Electrolux Building 14th Floor  
1910 New Phetchaburi Road,  
Bangkapi, Huai Khwang, Bangkok 10310  
Office Tel: (+66 2) 7259100  
Office Fax: (+66 2) 7259299  
Email: [customercarethai@electrolux.com](mailto:customercarethai@electrolux.com)

### Vietnam

Consumer Care Center Toll Free: 1800-58-88-99  
Tel: (+84 8) 3910 5465  
Electrolux Vietnam Ltd.  
Floor 9th, A&B Tower  
76 Le Lai street - Ben Thanh Ward - District 1  
Ho Chi Minh City, Vietnam  
Office Tel: (+84 8) 3910 5465  
Office Fax: (+84 8) 3910 5470  
Email: [vnccare@electrolux.com](mailto:vnccare@electrolux.com)

### Hongkong

Tel: (+852) 8203 0298  
Dah Chong Hong, Ltd. - Service Centre  
8/F., Yee Lim Godown Block C  
2-28 Kwai Lok Street, Kwai Chung, N.T.

**[www.electrolux.com](http://www.electrolux.com)**

**The Thoughtful Design Innovator.**

Do you remember the last time you opened a gift that made you say, “Oh! How did you know? That’s exactly what I wanted!” That’s the kind of feeling that we at Electrolux seek to evoke in everyone who chooses or uses one of our products. We devote time, knowledge, and a great deal of thought to anticipating and creating the kind of appliances that our customers really need and want.

This kind of thoughtful care means innovating with insight. Not design for design’s sake, but design for the user’s sake. For us, thoughtful design means making appliances easier to use and tasks more enjoyable to perform, freeing our customers to experience the ultimate 21st century luxury: ease of mind. Our aim is to make this ease of mind more available to more people in more parts of their everyday lives, all over the world.

The “Thinking of you” promise from Electrolux goes beyond meeting the needs of today’s consumers. It also means we’re committed to making appliances safe for the environment—now and for future generations.

Electrolux. Thinking of you.

Share more of our thinking at  
**[www.electrolux.com](http://www.electrolux.com)**